

Building Instructions

RileyRover Base Design and Attachments

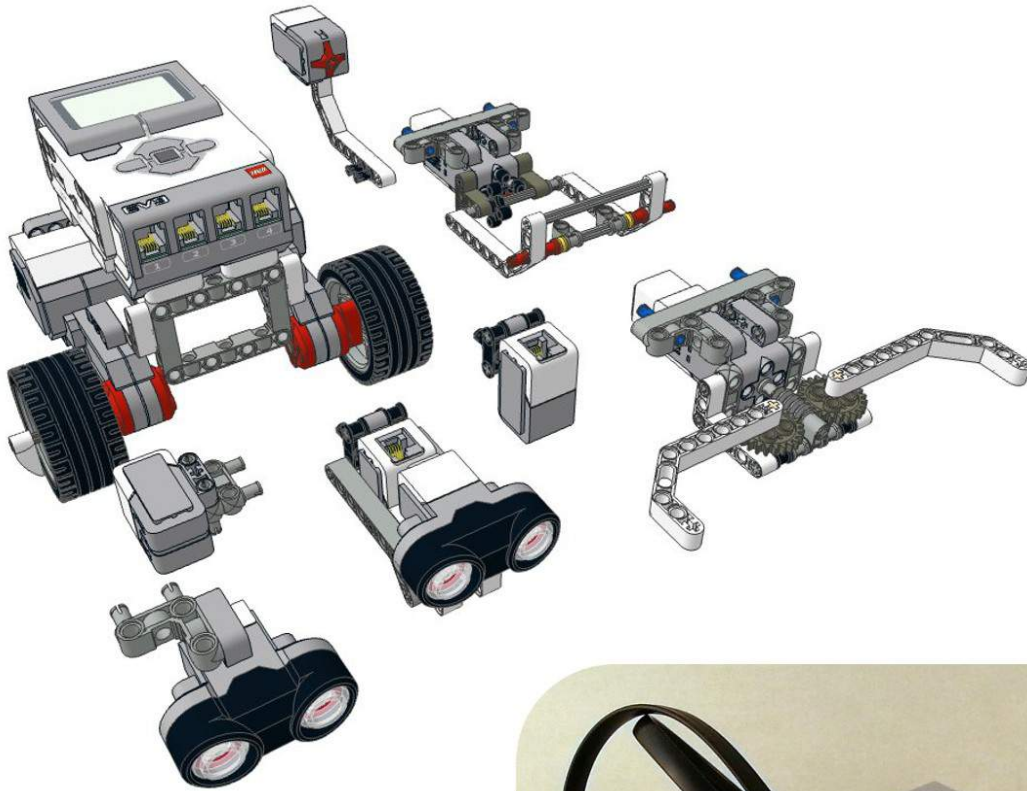

Please Share!
Attribution to
www.damienkee.com

Not for commercial use unless
prior permission granted.

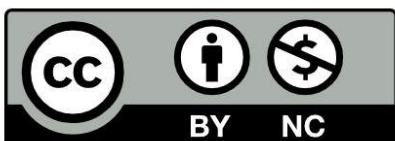

Sensor and Motor Attachments for the RileyRover Base design



Ultrasonic Sensor

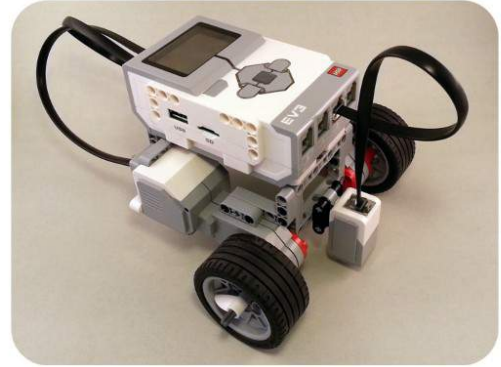

Colour Sensor



Gyro Sensor



Gripper

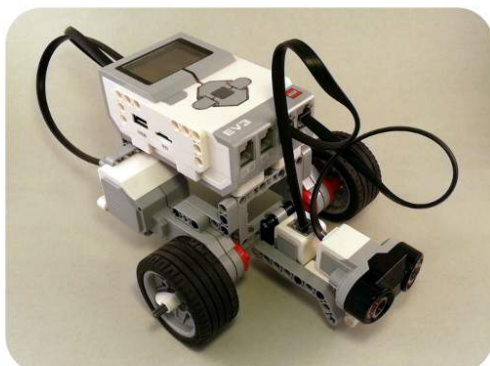

Colour / Ultrasonic combination

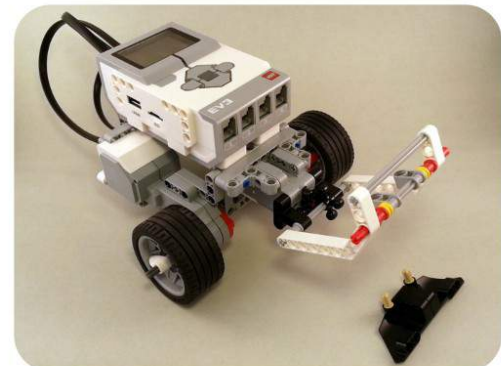

Cargo Delivery

Right Motor Assembly

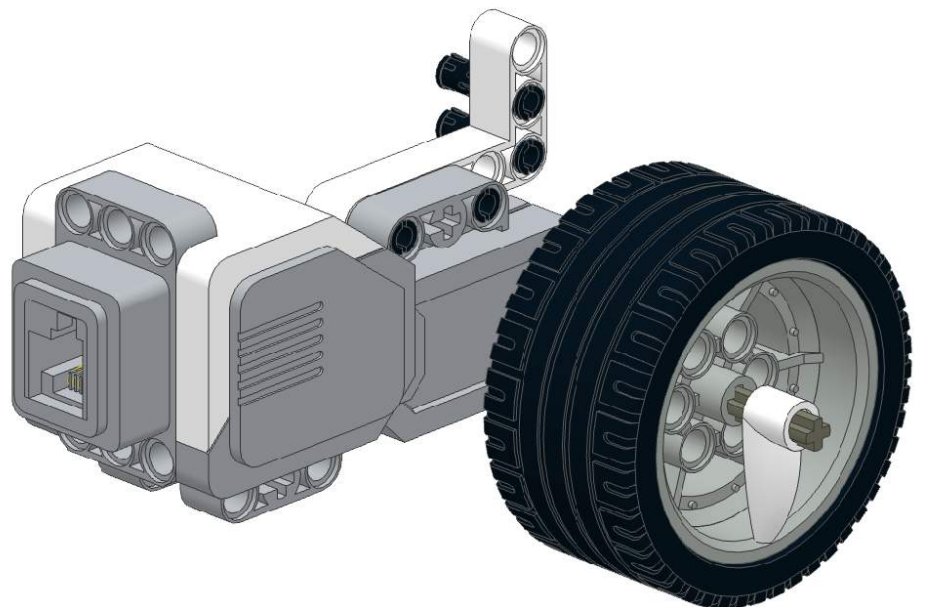
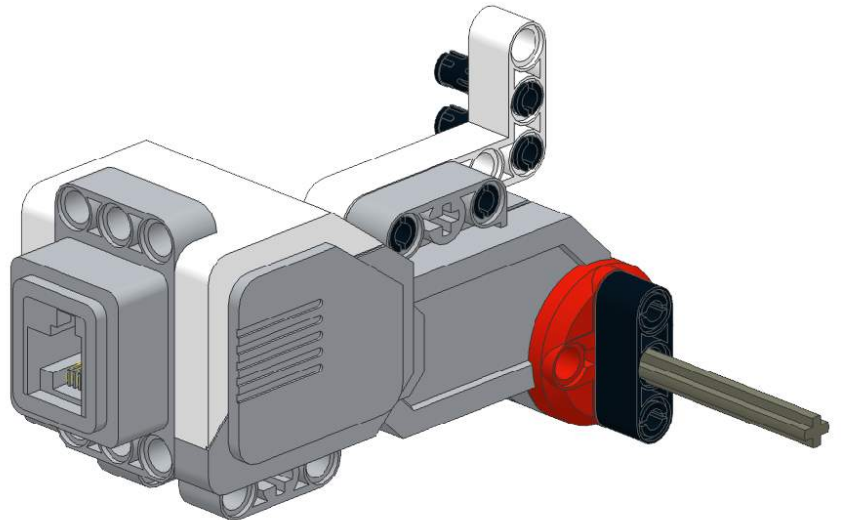
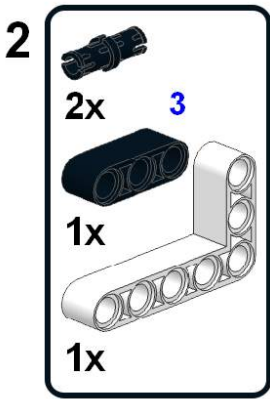
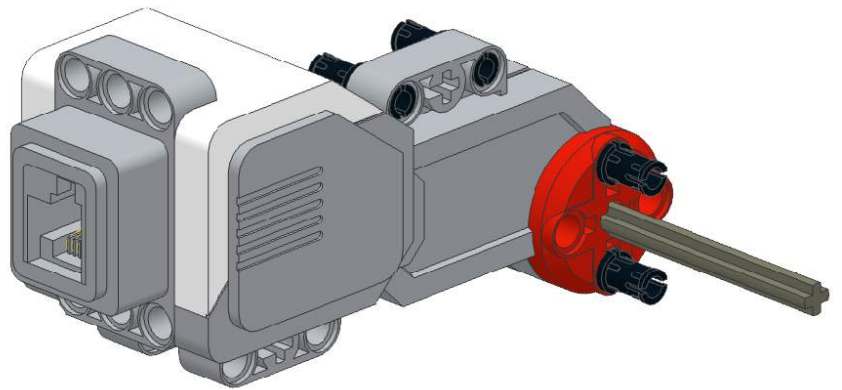
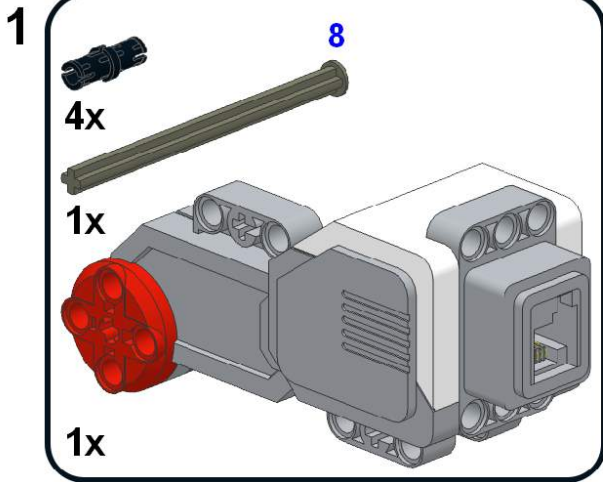

Left Motor Assembly

1

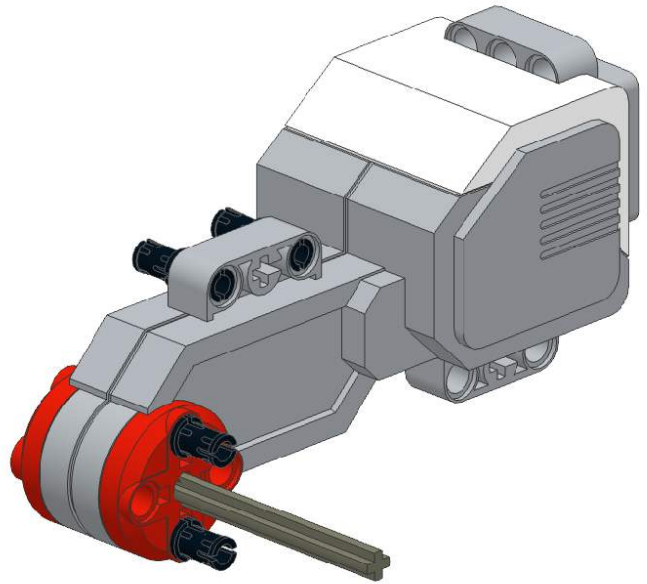
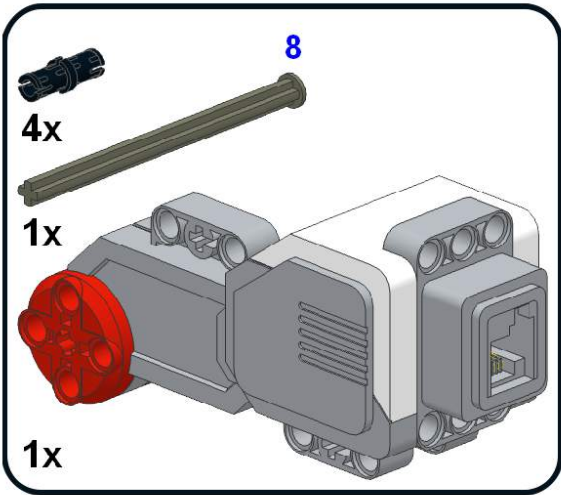

2

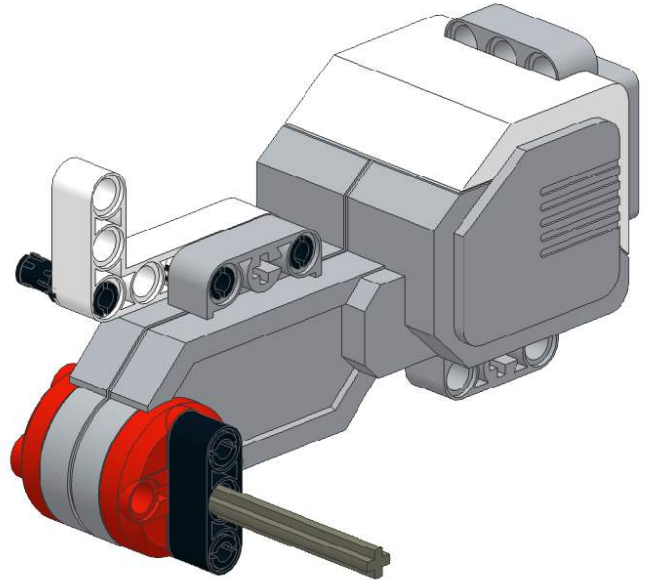
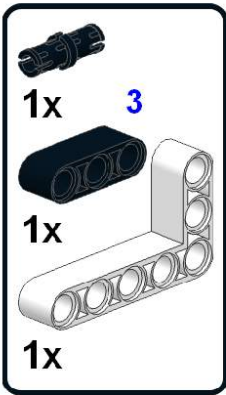

3

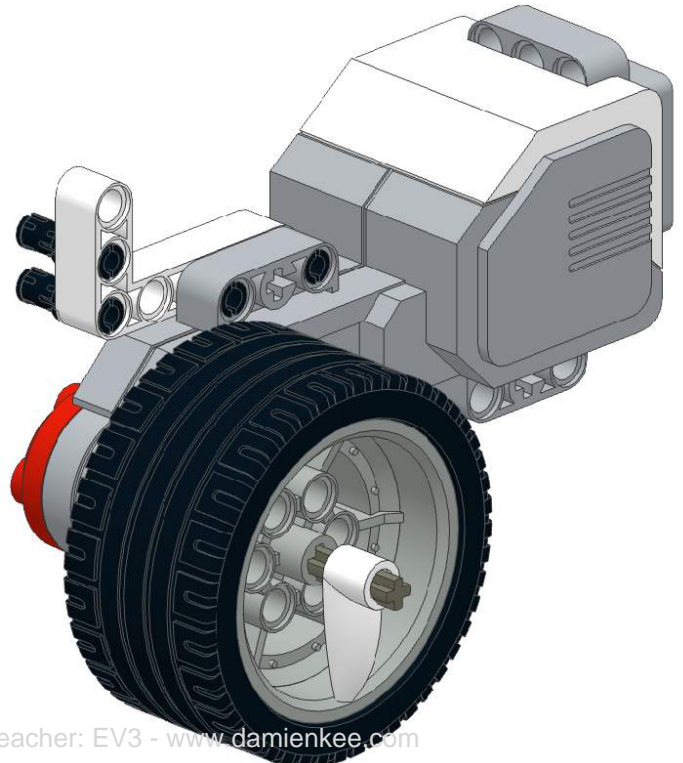

Back Castor Assembly

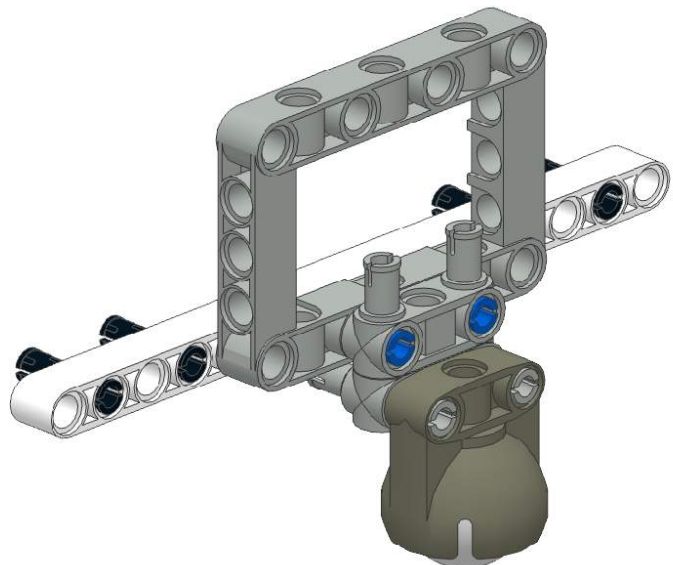
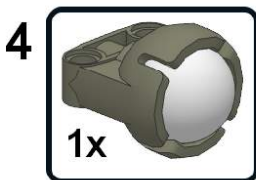
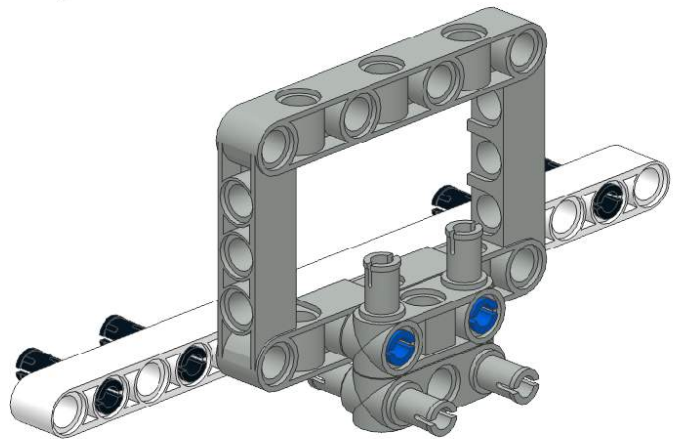
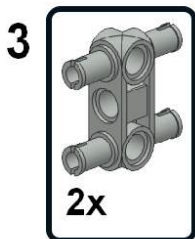
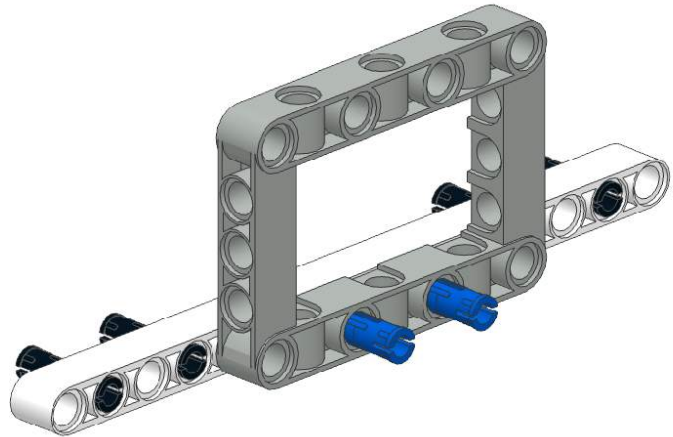
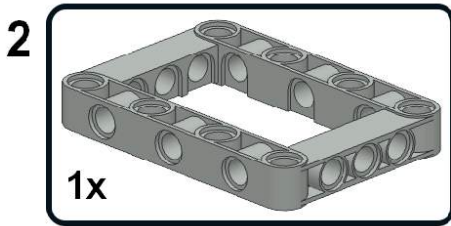
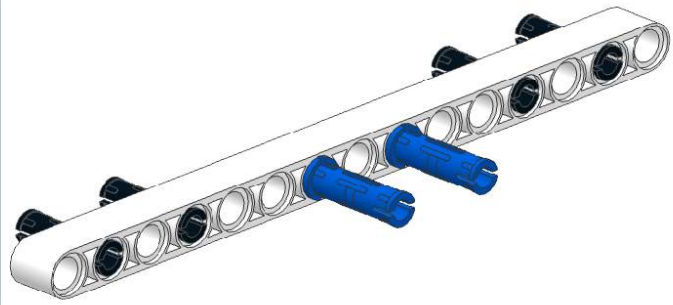
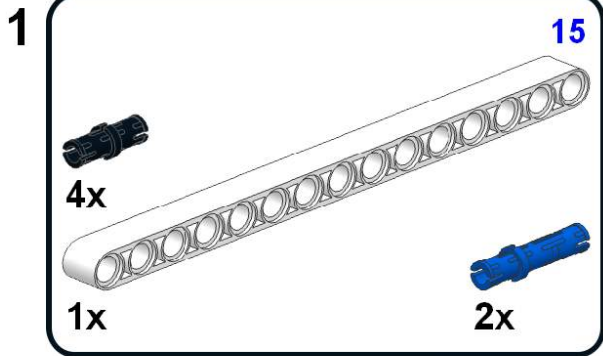

Assemble Right Motor, Left Motor and Back Castor

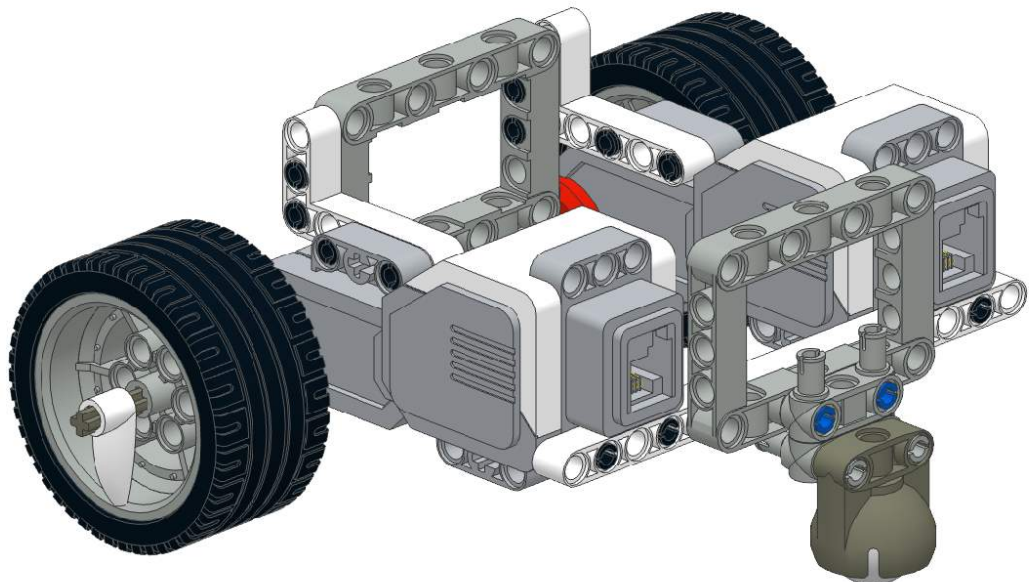
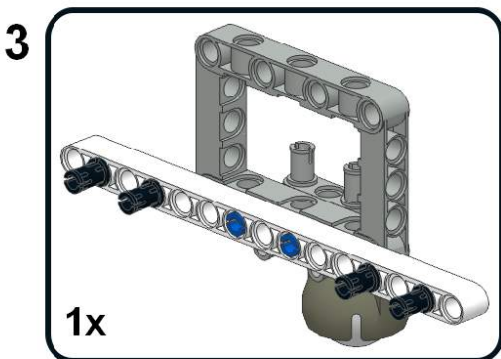
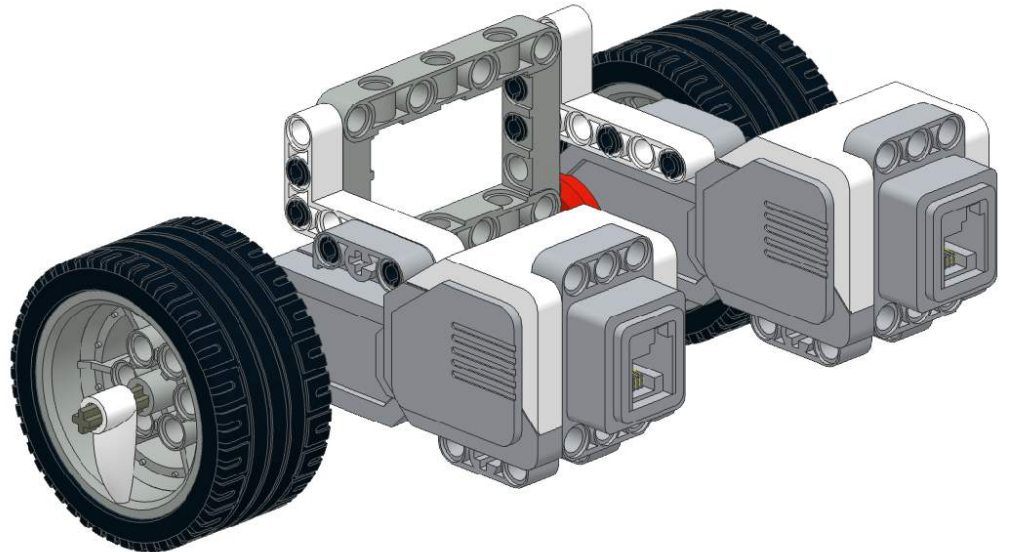
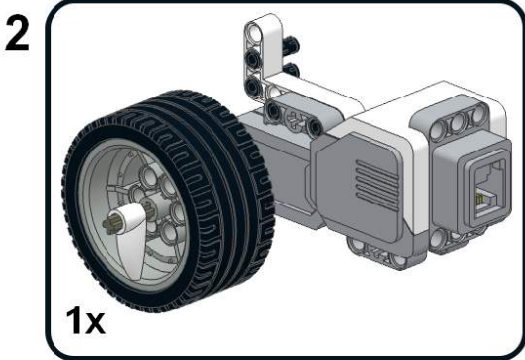
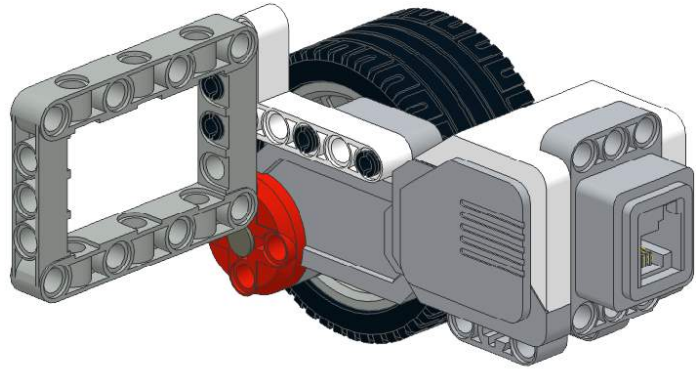
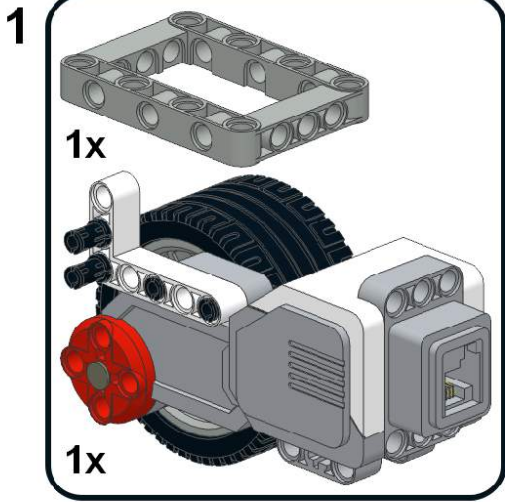

Turn Base around

4

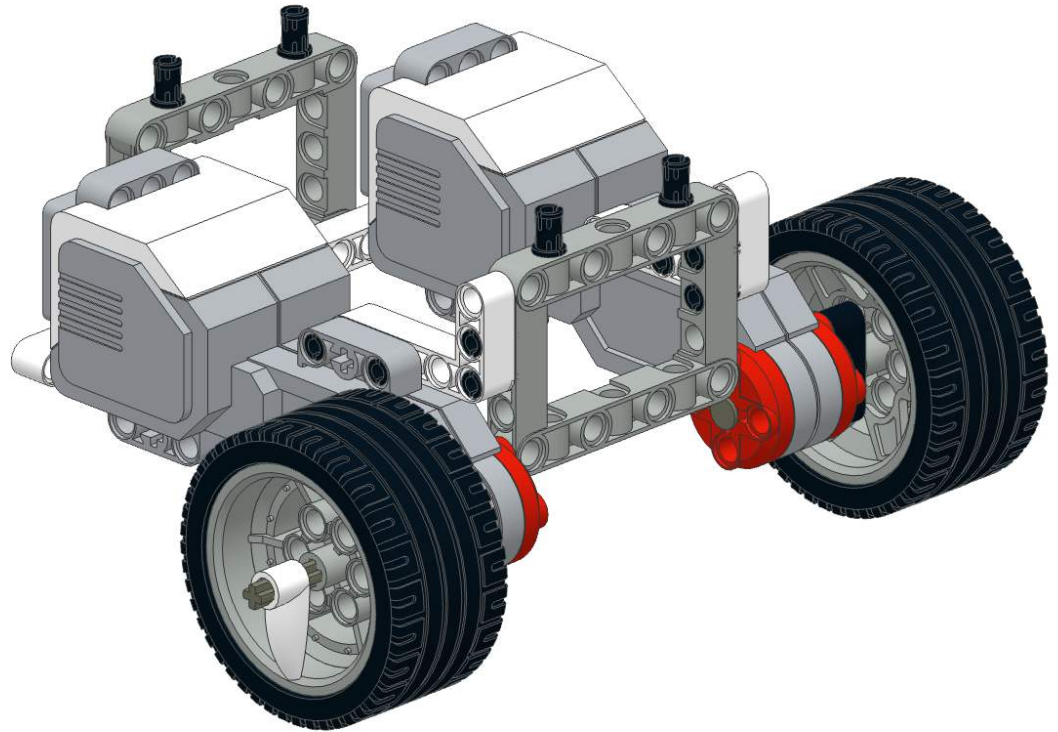

5

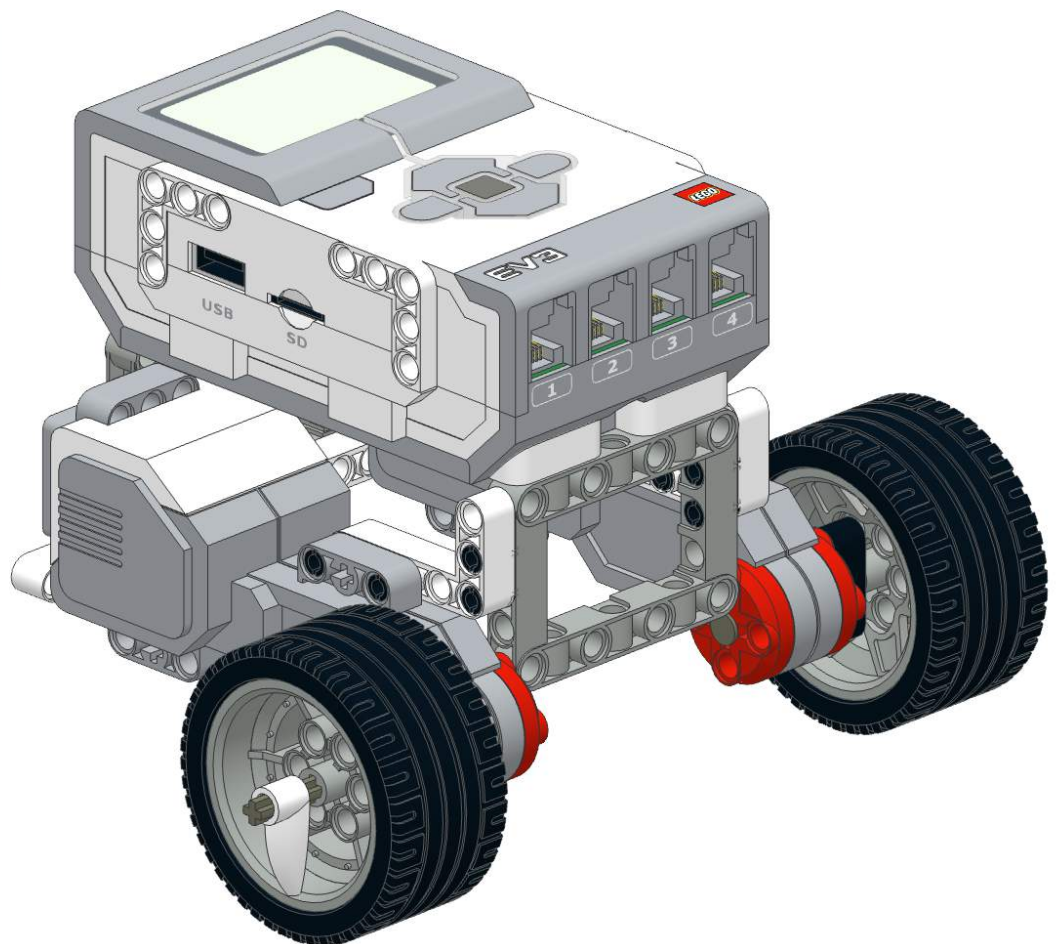
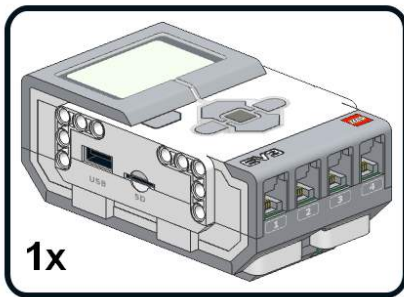

Connect the Cables

Left Motor : B - Right Motor : C
(for this design, the cables will cross over)

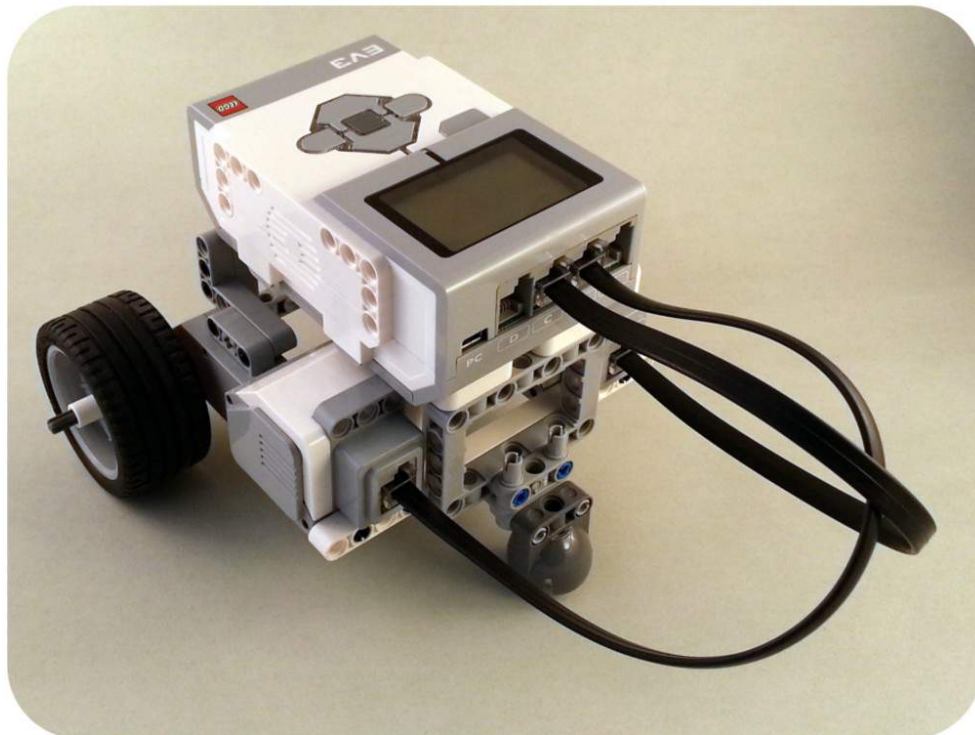

Ultrasonic Sensor Attachment

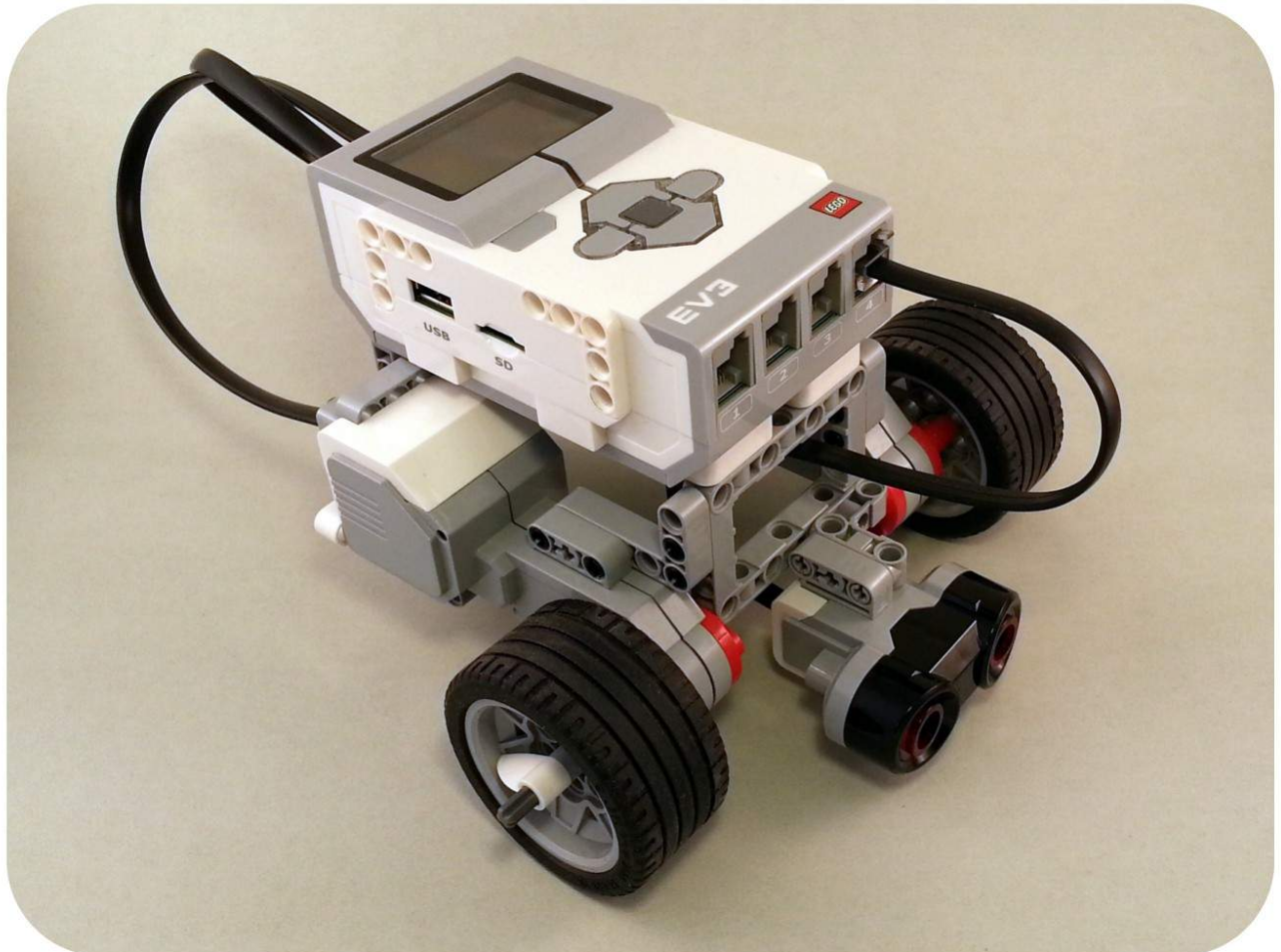
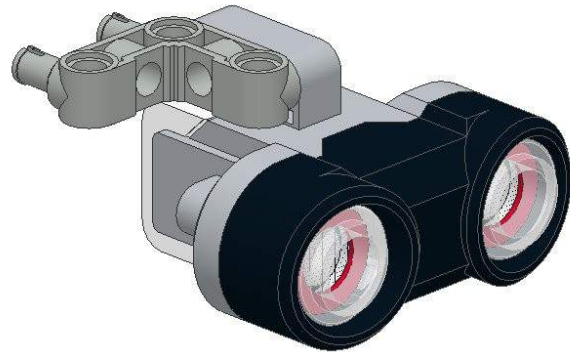
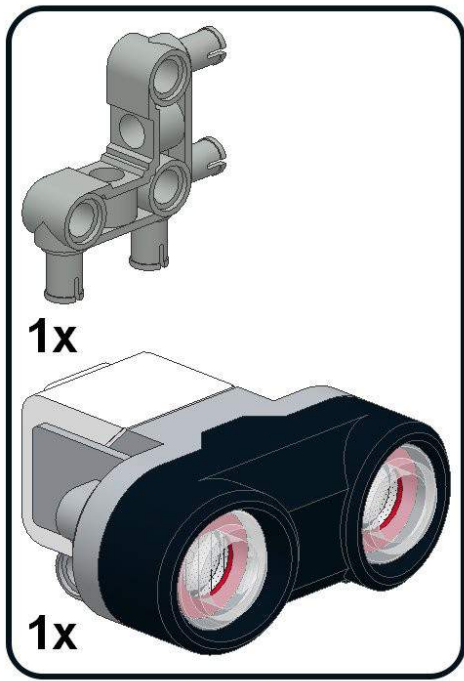

Colour Sensor Attachment

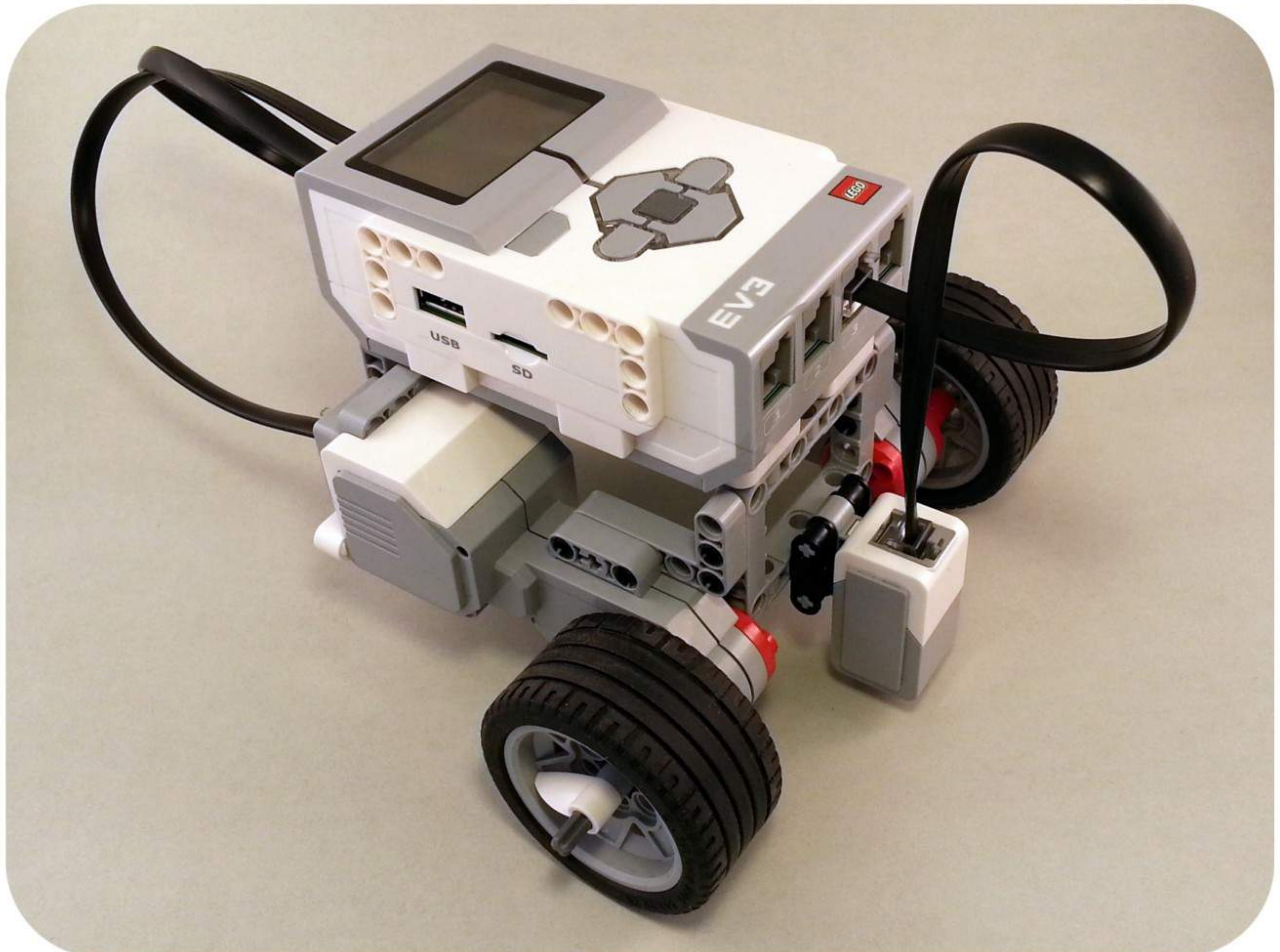
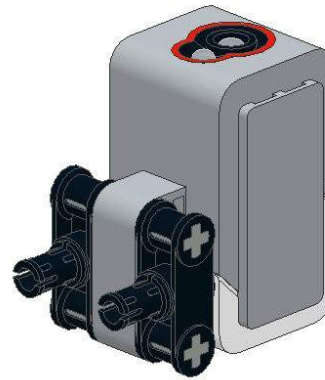
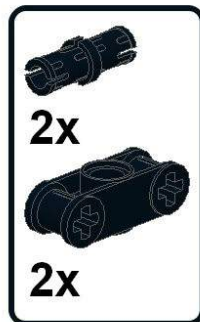
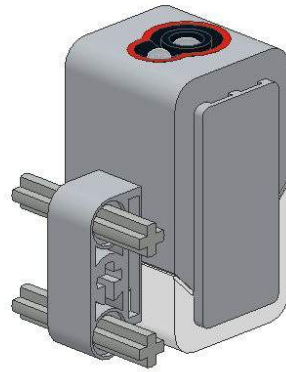
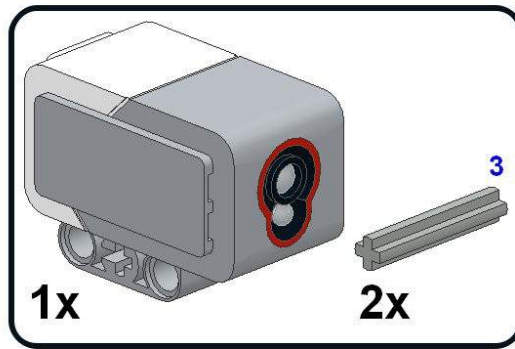

Gyro Sensor Attachment

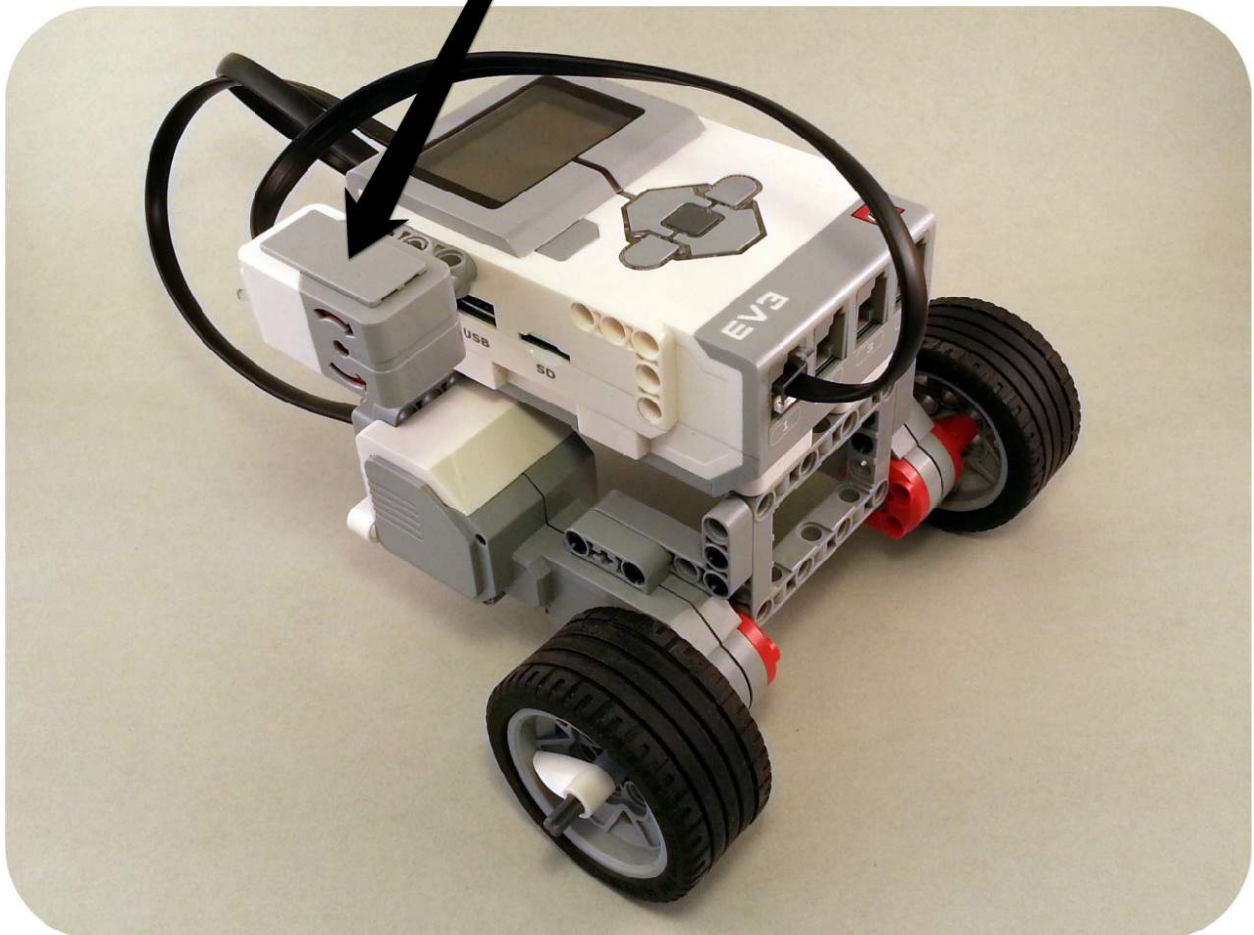
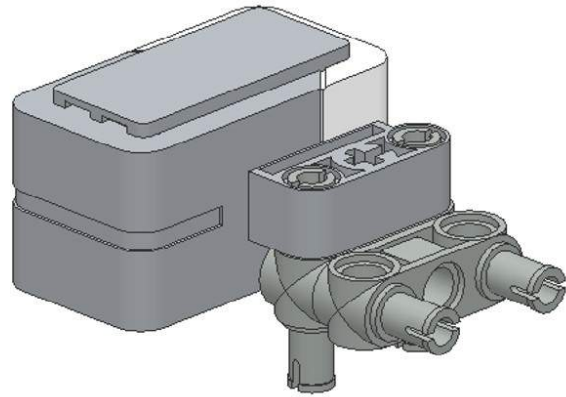
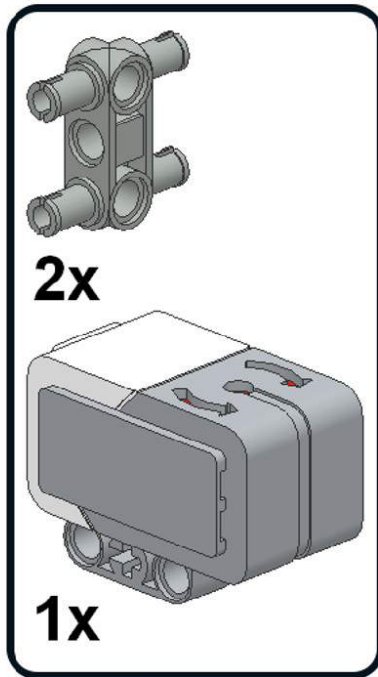

Touch Sensor Attachment

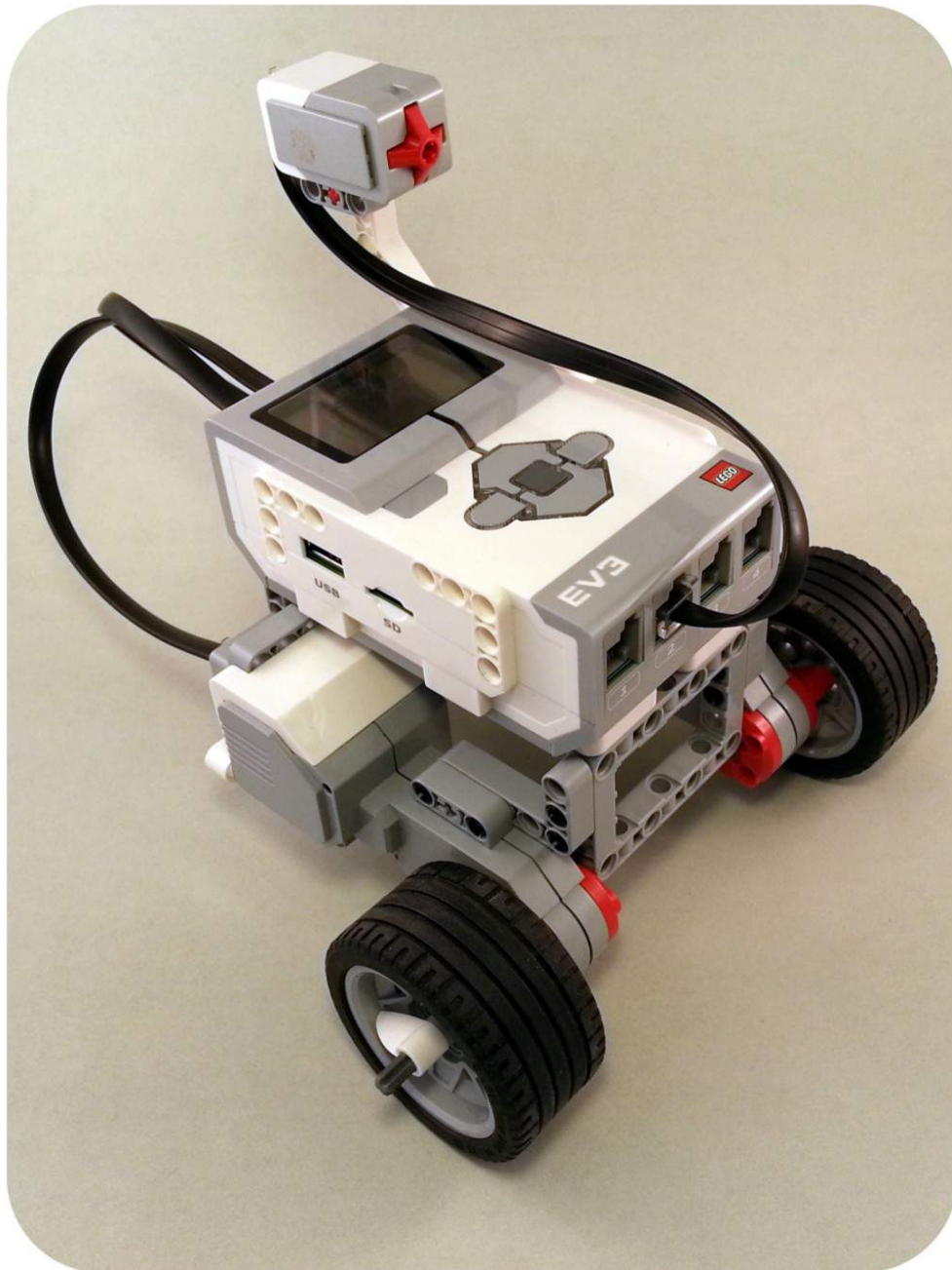
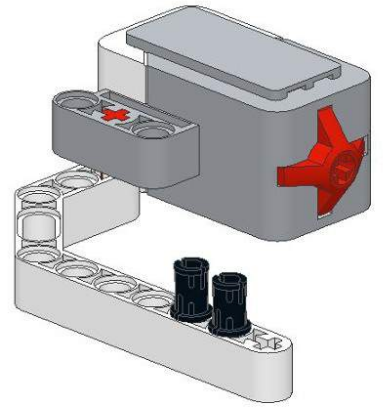
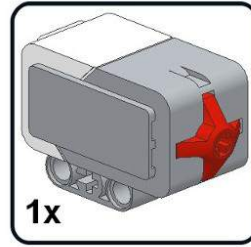
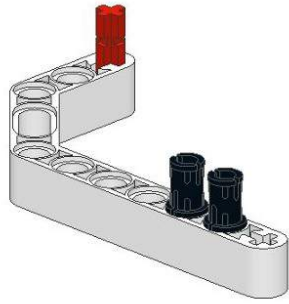
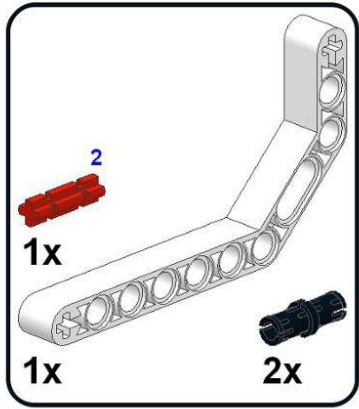

Gripper Attachment

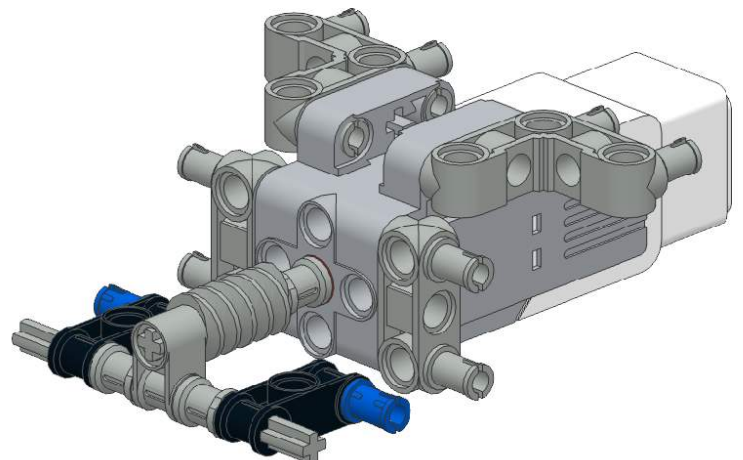
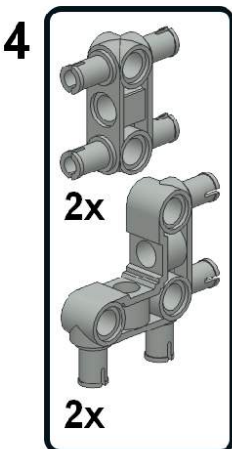
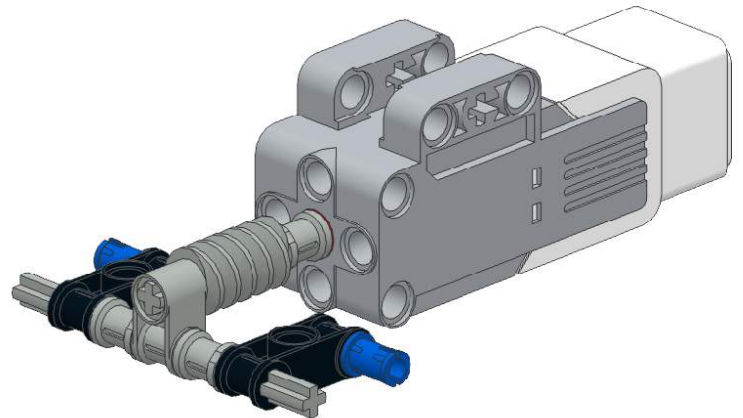
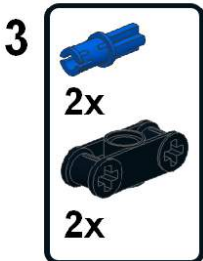
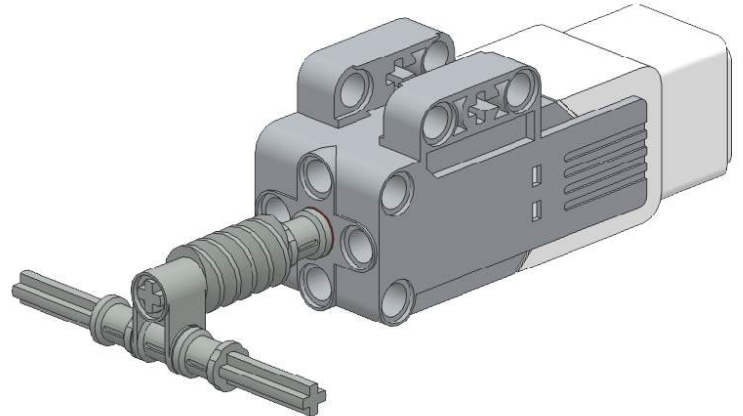
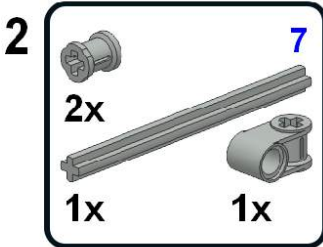
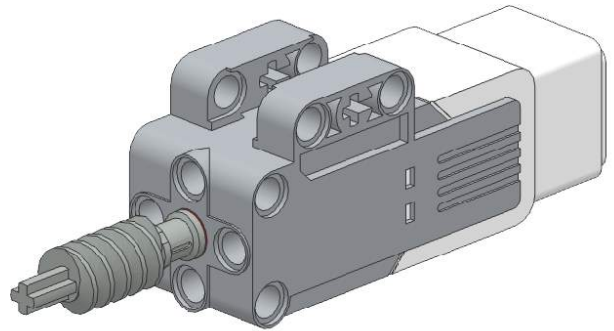
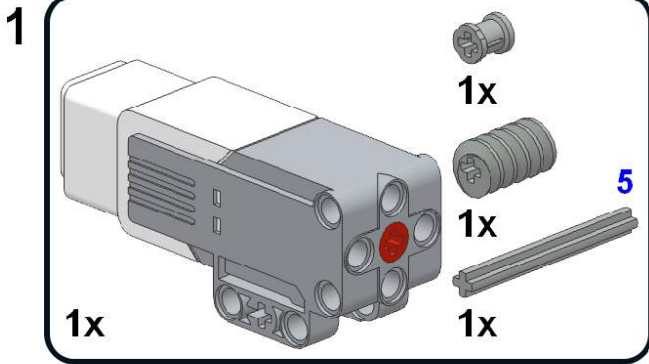

5

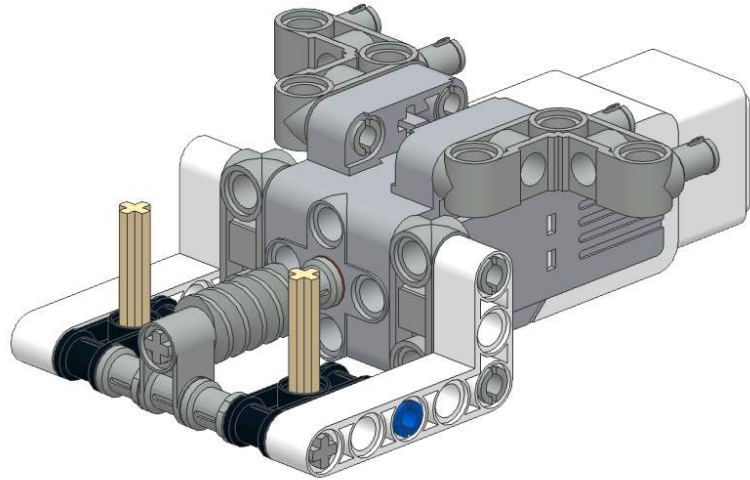
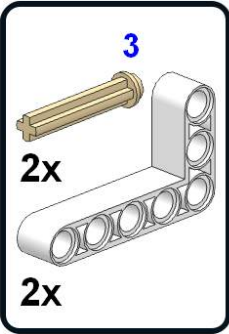

6

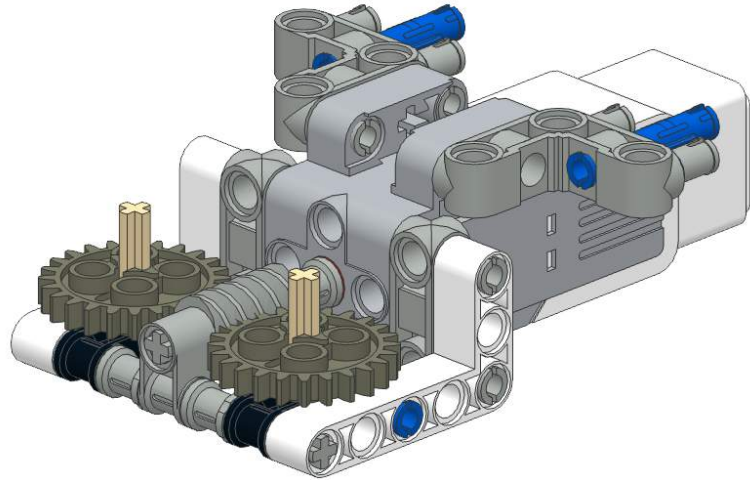

7

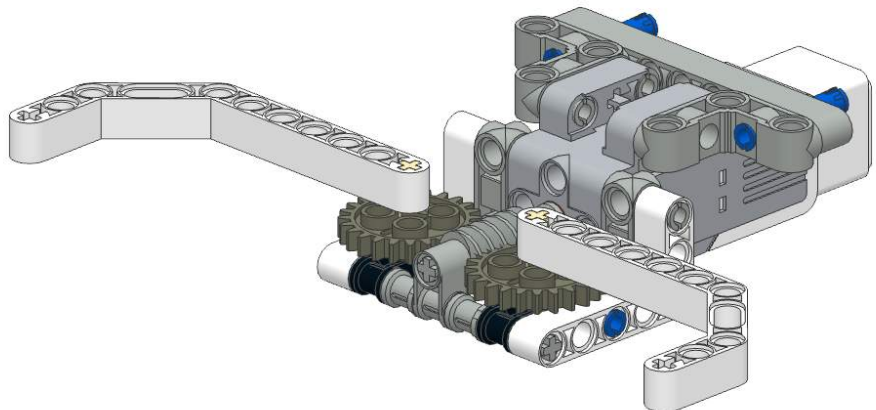
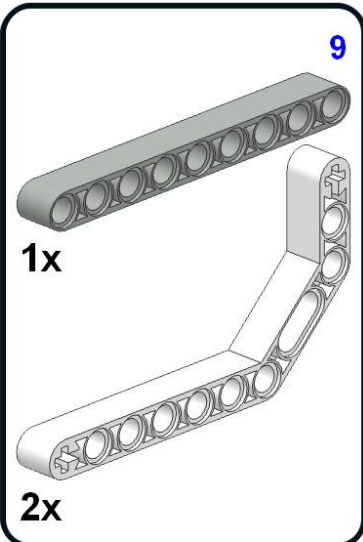

Attach the Gripper to the front of the Robot

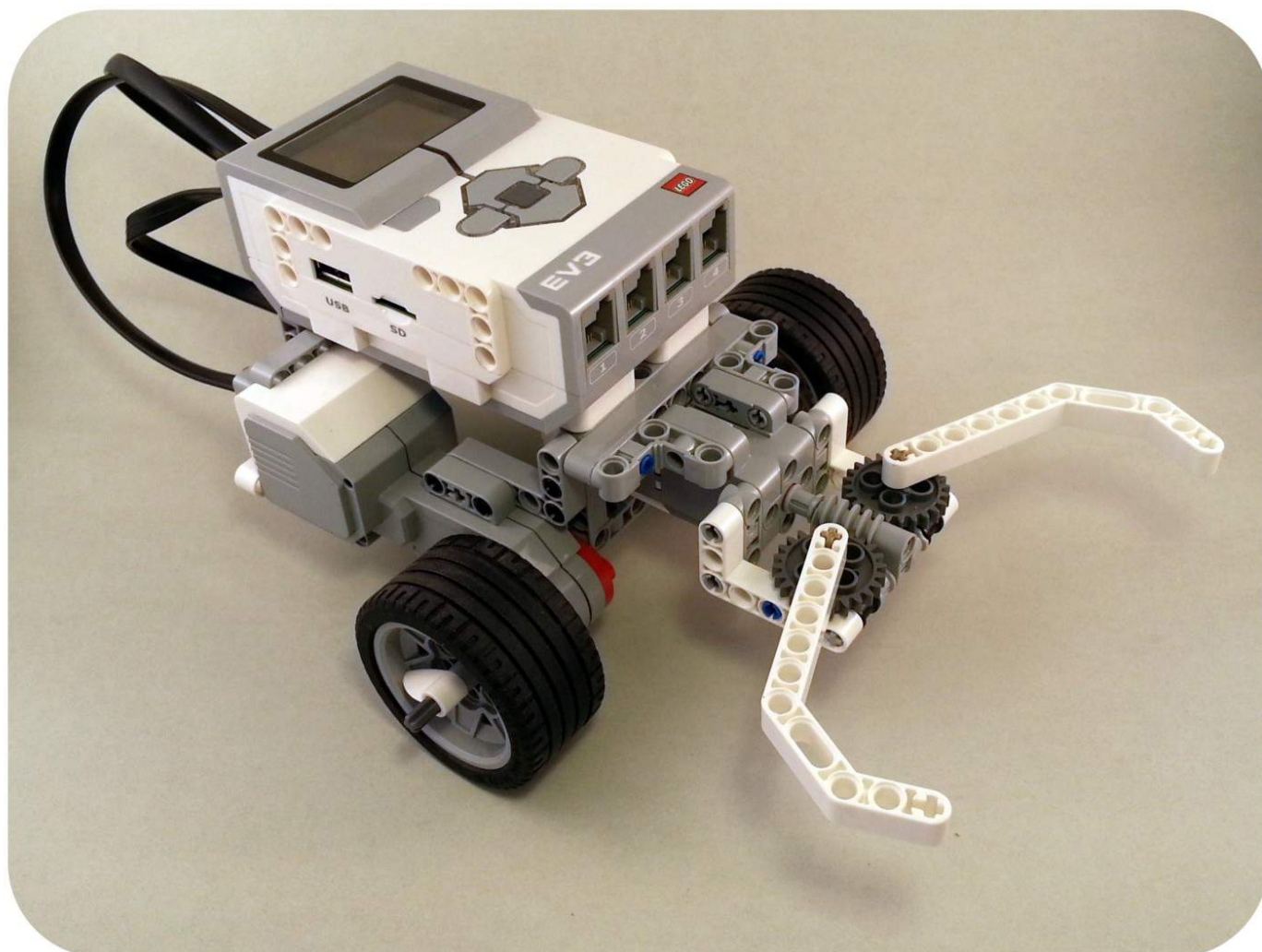
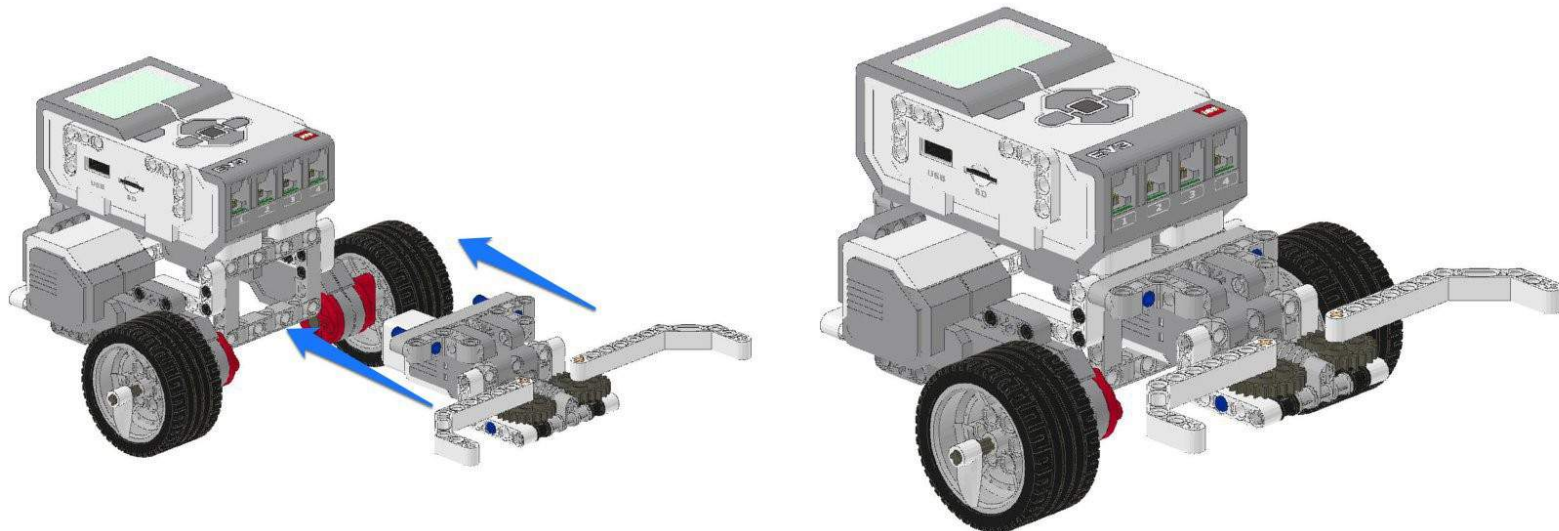

Cargo Delivery Attachment

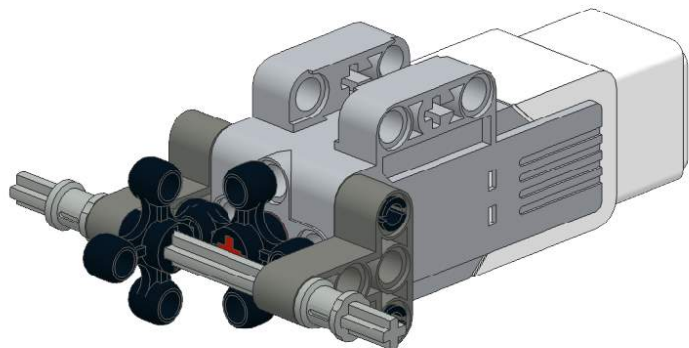
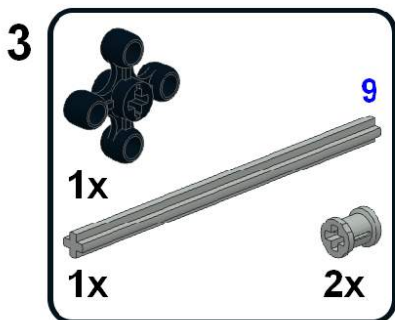
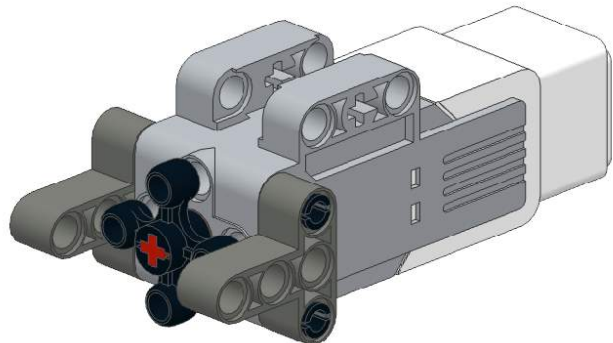
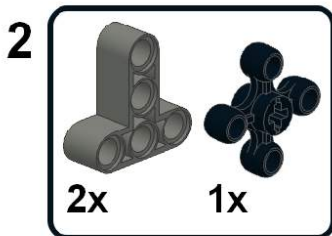
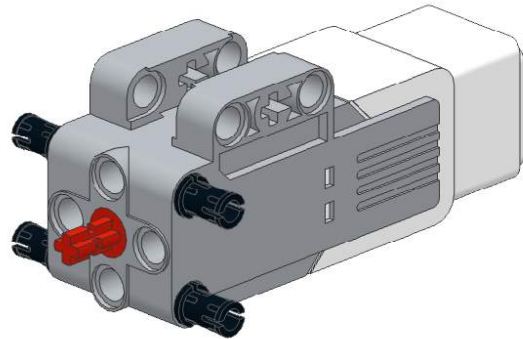
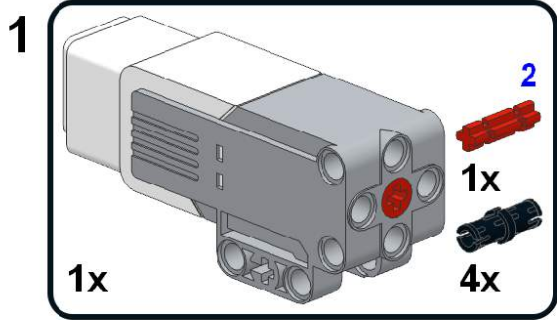

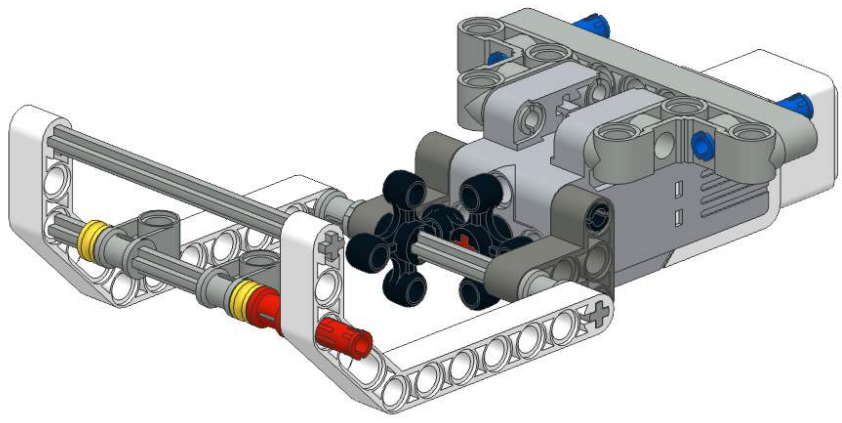
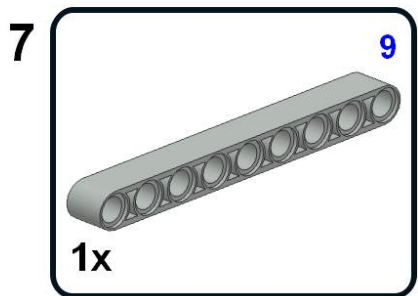
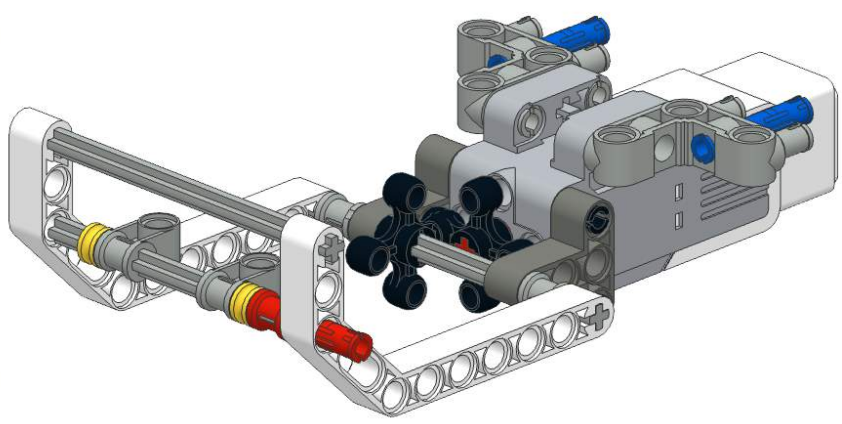
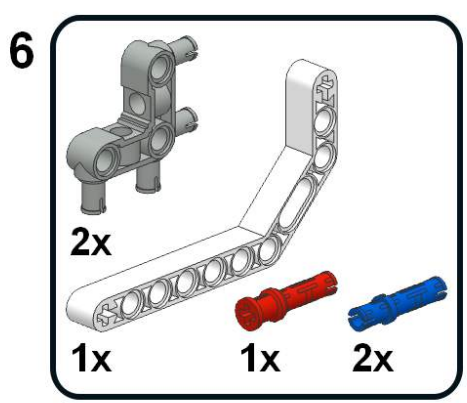
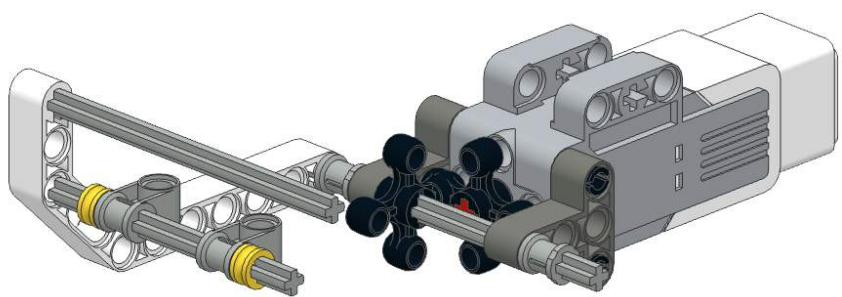
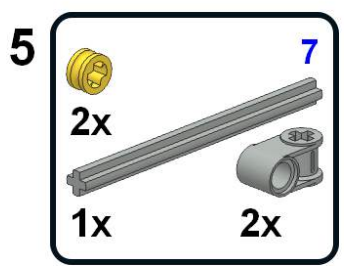
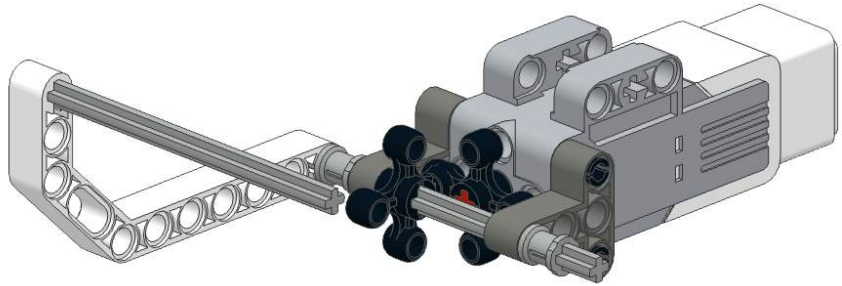
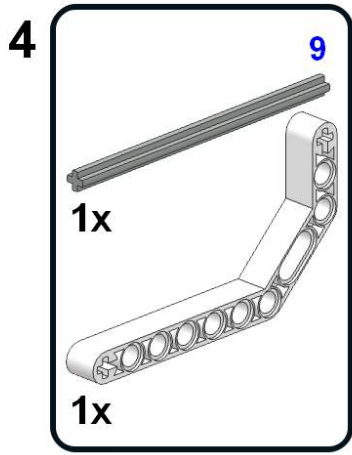

Signal Repeater

To be used with the Cargo Delivery Attachment

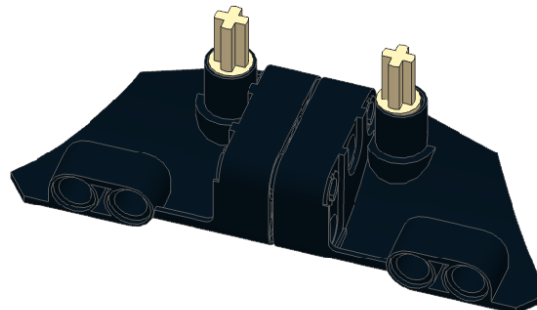
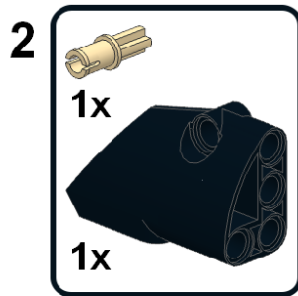
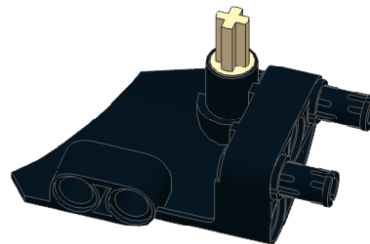
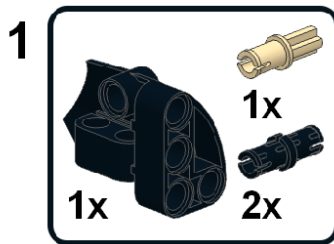

Attach the Cargo Delivery Attachment to the front of the Robot

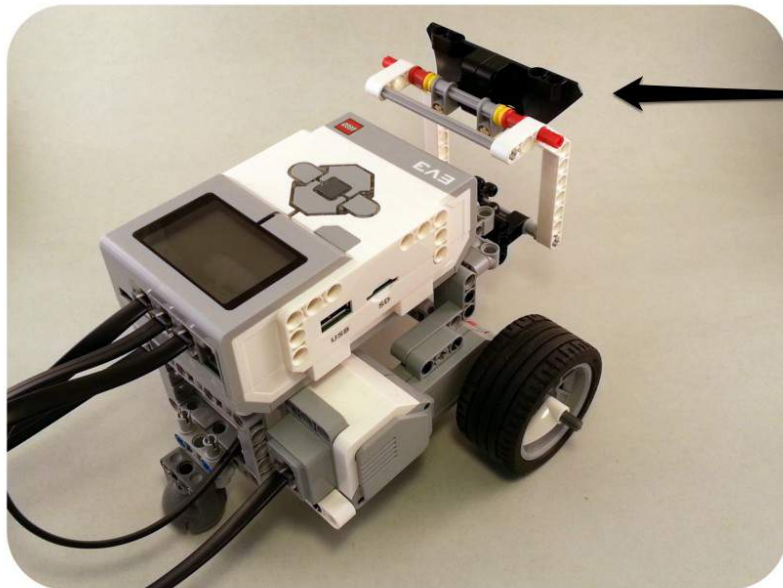
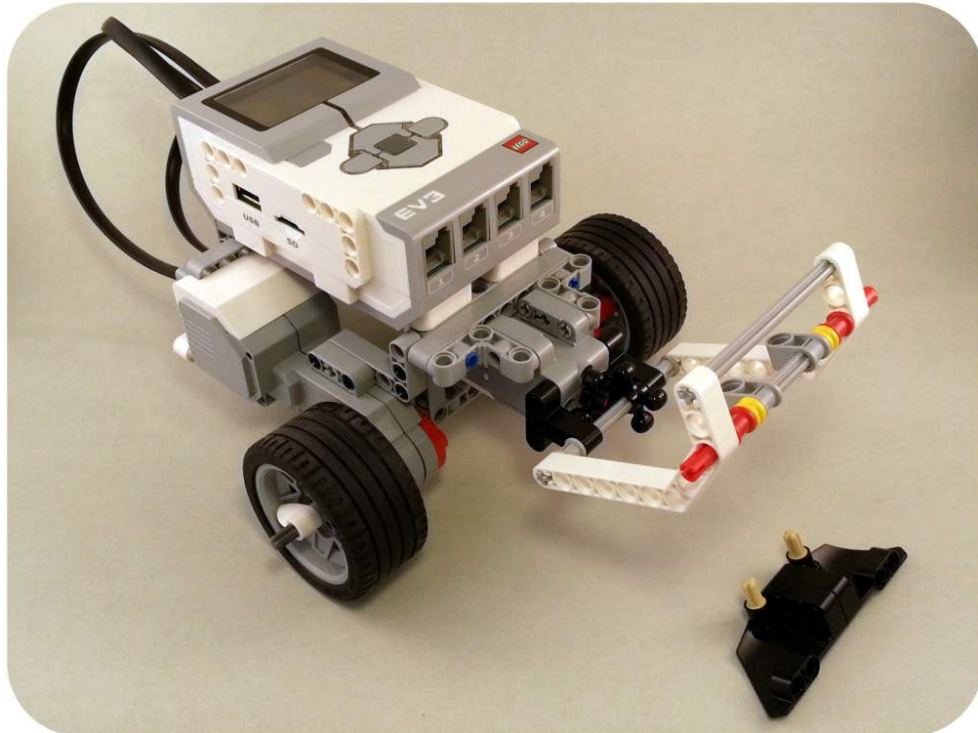

The 'Signal Repeater' will sit loosely in the Cargo Delivery arm when in a raised position. Lower the Cargo Delivery arm to drop the Signal Repeater

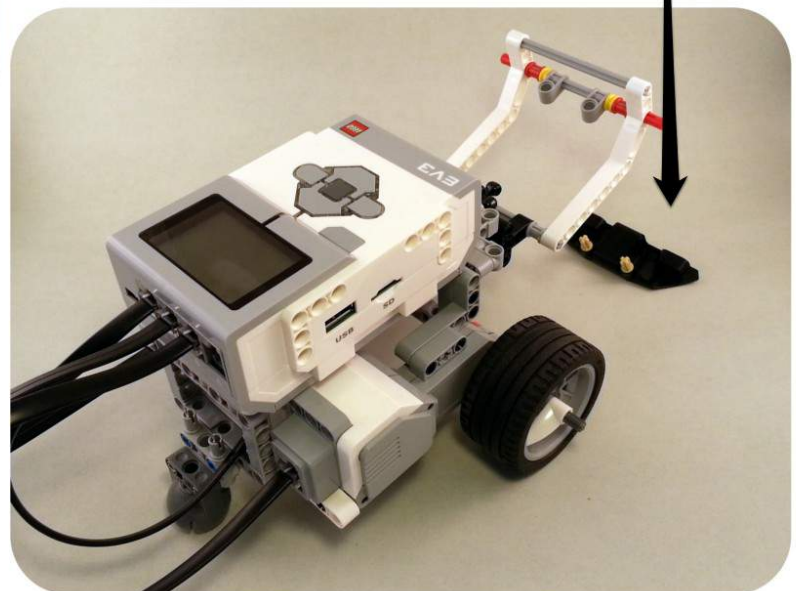

The Ultrasonic Sensor Attachment can be used with both the Cargo Delivery Attachment and Gripper Attachment

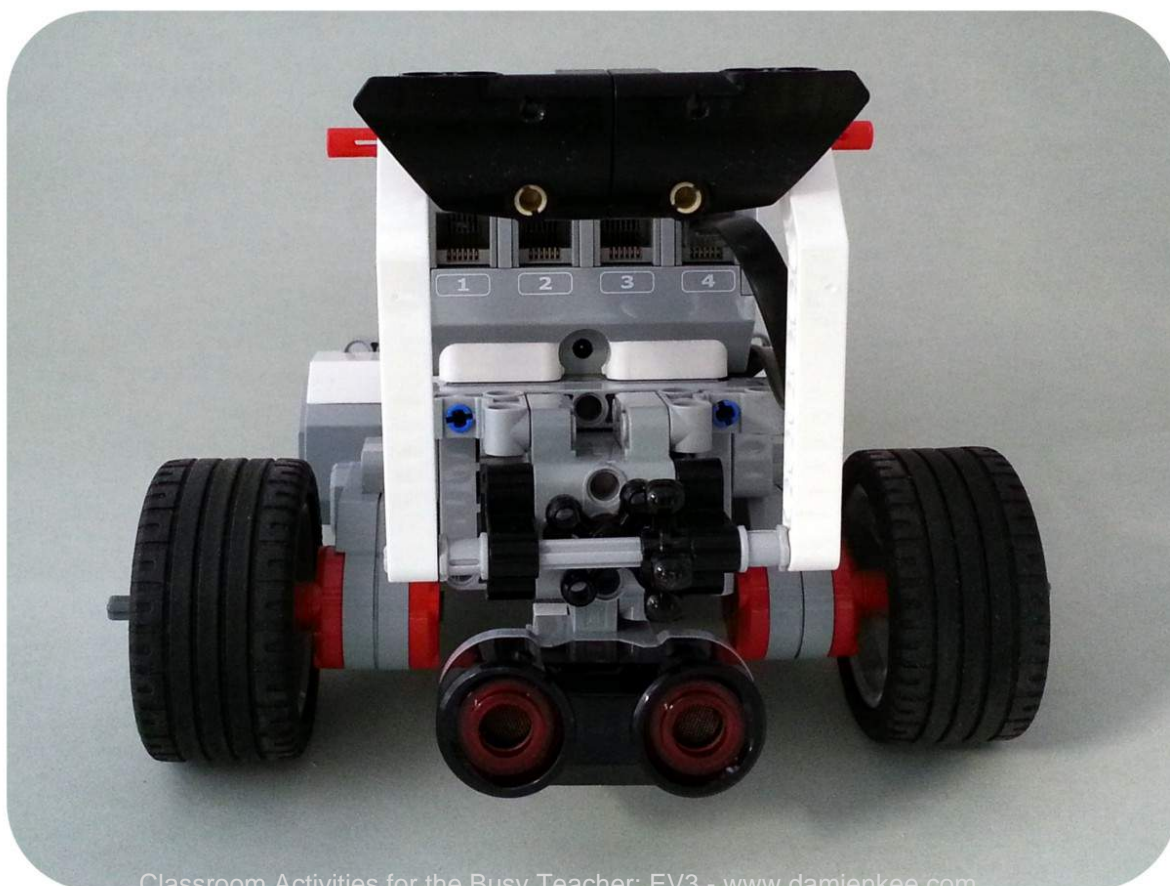
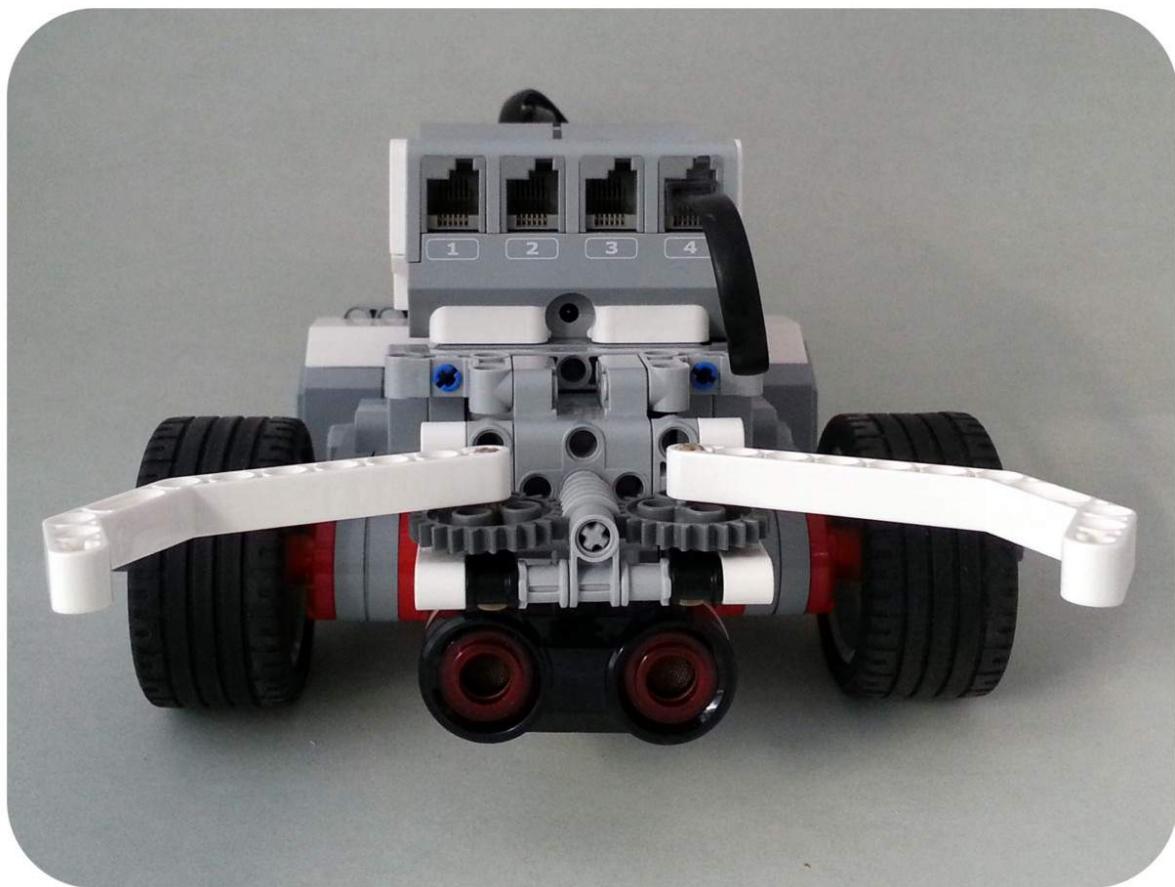

Combined Colour - Ultrasonic Sensor Attachment

1

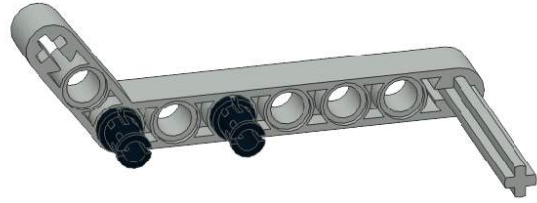
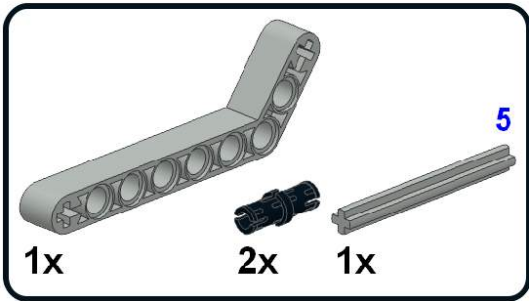

2

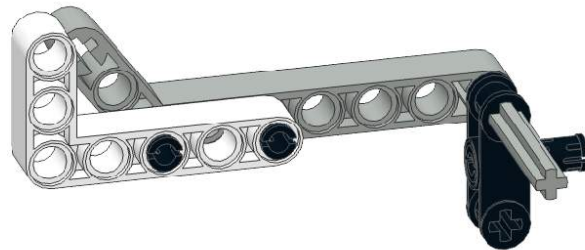
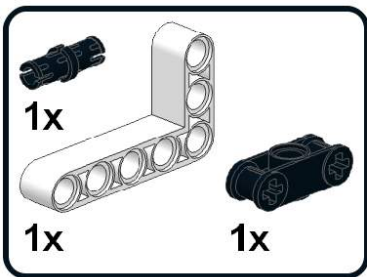

3

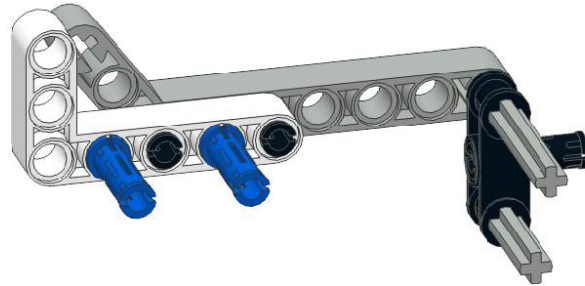
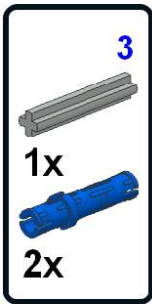

4

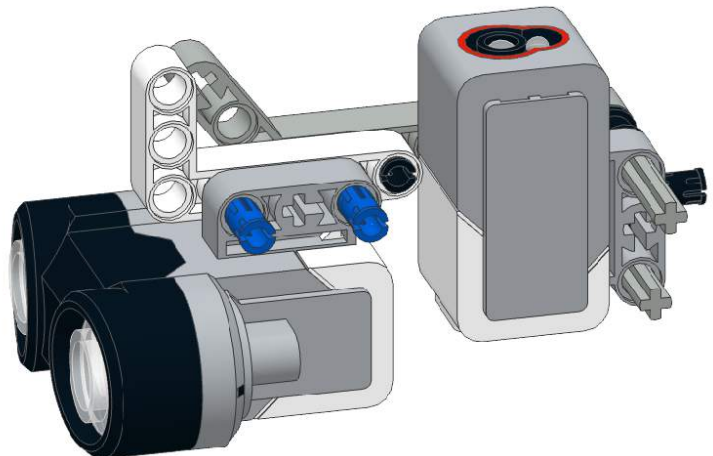
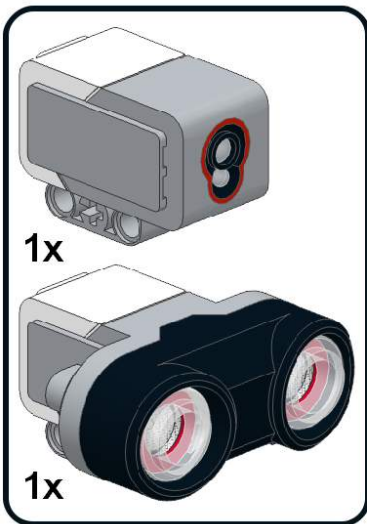

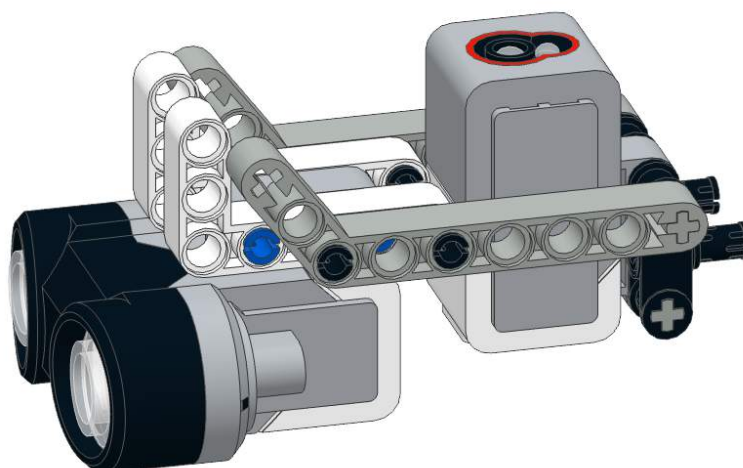
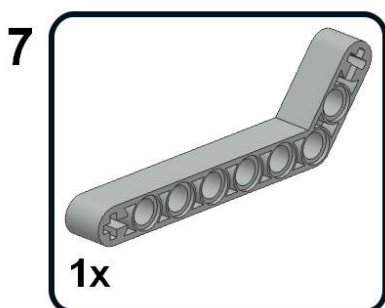
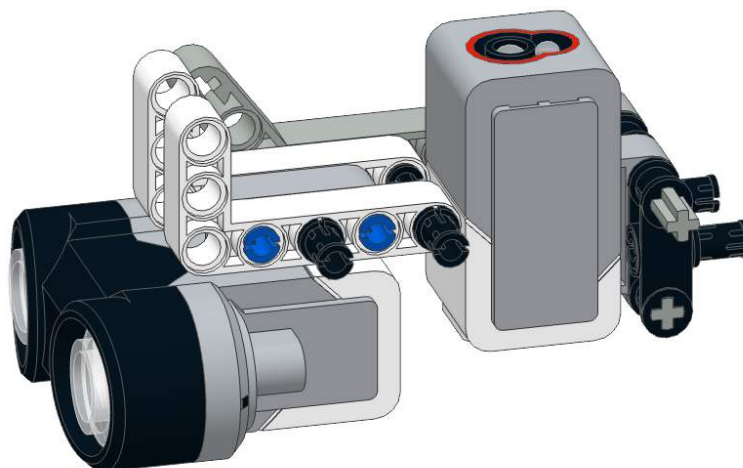
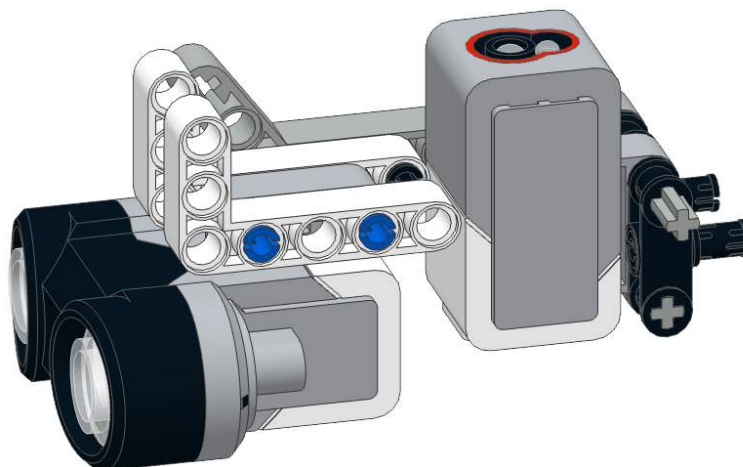
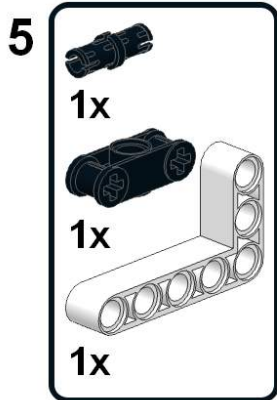

Snap the combined Colour-Ultrasonic Sensor Attachment to the front of the robot

